

JOB NAME:

QUANTITY:

ITEM NO.:

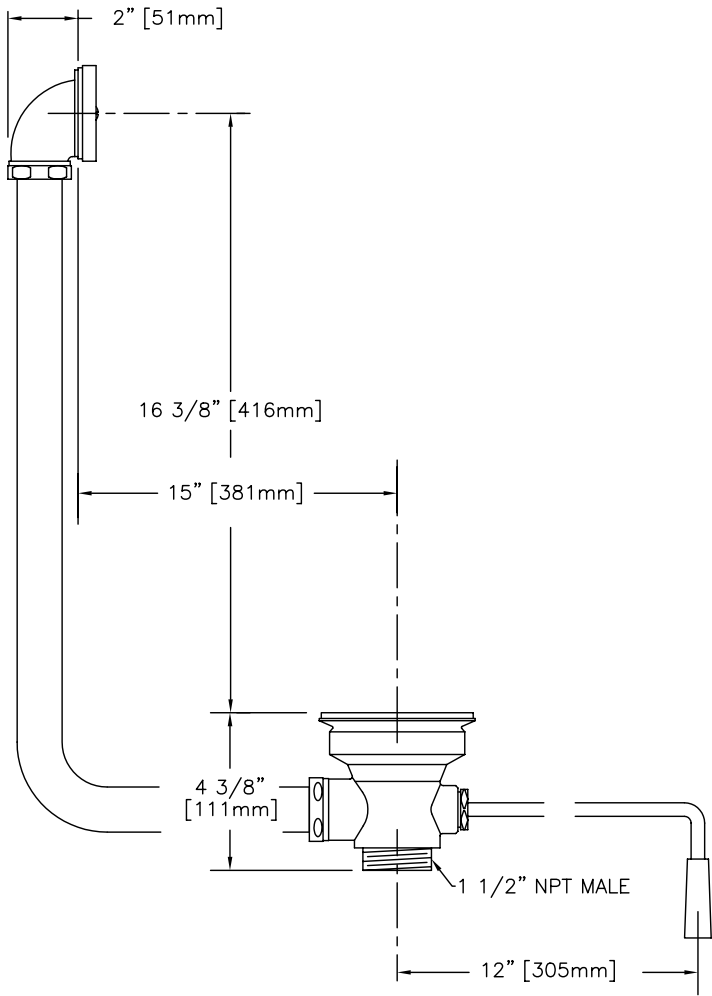

PRODUCT NAME:

TWIST WASTE VALVE

_____ SPECIAL CONFIGURATION
(CHECK BASE MODEL AND OPTIONS)

MODEL:

24880 WITH BASKET STRAINER
& 14" X 18" OVERFLOW

OPTIONS OR MODIFICATIONS:

OTHER _____

FEATURES:

- * 3 1/2" SINK OPENING
- * 1 1/2" DRAIN OPENING
- * CAST BRONZE BODY AND WORKING PARTS
- * CHROME PLATED BODY AND WORKING PARTS
- * BASKET STRAINER
- * CSA CERTIFIED

DRAIN RATE:

* 12 GPM

SHIPPING WEIGHT

* 6.4 LBS

ROUGH-IN:

OVERFLOW:

DRAIN:

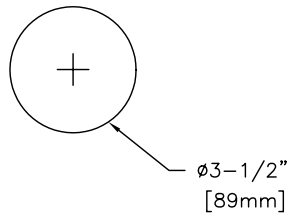
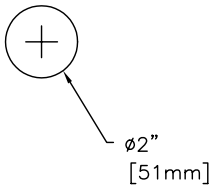

ANSI/A112.18.1M

Distributed by Fisher Manufacturing Company
 P.O. Box 60 Tulare, CA 93725-0060
 Phone 800-421-6162 FAX 800-8-FAUCET (800-832-8238)